

Info

1 Quarter turns



2 Rod controls



3 Locking systems



4 Hinges



5 Gasketing

6 Handles

7 Aluminium windows

8 Stainless steel



STAINLESS STEEL

Spring loaded

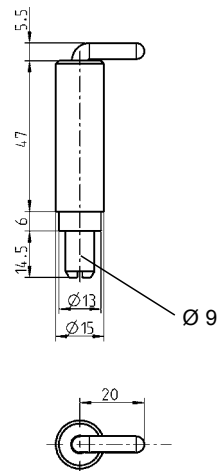
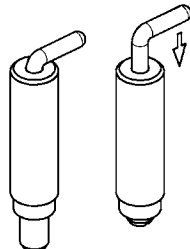

Pin hinge AISI 304, pin AISI 303, spring stainless steel

1117-U1-PF



STAINLESS STEEL

Spring loaded

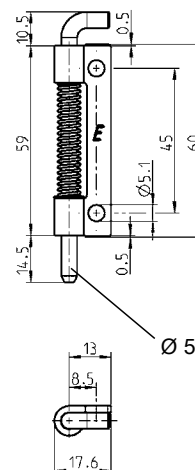
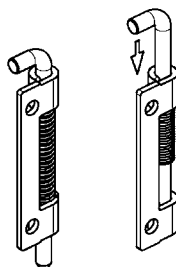

Pin hinge AISI 304, pin AISI 303, spring stainless steel

RH

1117-U4-PC

LH

1117-U5-PC