



AGENT E Wired – Schwenkgriff mit / ohne integrierten Kartenleser

Die Schwenkgriffe der Baureihe AGENT E Network sind mit und ohne integrierten Kartenleser verfügbar. Die Griffe werden über das Anschlusskabel an die Access Unit 3000-U47-02 des ELM Systems angeschlossen. Diese Unit dient zum Öffnen von 2 Griffen der Baureihe AGENT E RFID 3000-U900-3x/-4x und zum Ansteuern der im Griff eingebauten Alarm LED. Die Freischaltung des Griffes erfolgt entweder über Netzwerk, externe Tastatur oder Transponderkarte. Nach der Freischaltung blinkt die rechte LED im Griff. Durch Berühren des transparenten Sensorfeldes im Griff erfolgt die Öffnung.

Technische Änderungen vorbehalten. Weiterführende Informationen unter www.emka-electronics.com.



AGENT E Wired – Swing Handle with / w/o Card Reader

Swing Handles series AGENT E Network are available with and without built-in RFID card reader. Via connecting cable with RJ45 connector the handles are plugged into the Access Unit 3000-U47-02 of the ELM system. This unit is used to open 2 electronic locks type AGENT E RFID 3000-U900-3x/-4x and to drive the built-in alarm LED of the lock.

Releasing the handle is via network, external keypad, or RFID card. After successful release, the right LED in the handle will start blinking. Touch the transparent sensor field to open the handle.

Subject to technical changes. Further information can be found under www.emka-electronics.com.



Power supply: 12 ... 24V DC, 15 / 50 mA
 Connecting cable: 4 m, with RJ45 connector
 Card Icon: indicates a handle with built-in card reader

RFID cards: 125 kHz Prox (3000-U900-3x)
 13.56 MHz (3000-U900-4x)



Pin	Signal	Pin	Signal
1	LED GN*	5	+12VDC
2	Data0	6	status contact
3	GND	7	Data1
4	Coil / Motor	8	LED RD*

Fig. 3: Pin out of RJ45 connector

Fig. 1: AGENT E RFID Network

Fig. 2: Handle LEDs, Sensor Field and Reader Area

Open handle procedure



Fig. 4: Show card to reader
 left LED is lit if valid card type detected.
 Right LED starts blinking if card is authorized



Fig. 5: With right LED blinking,
 touch sensor field to open the handle

Emergency opening



Fig. 6: Emergency opening via USB port;
 requires special software and
 USB <-> USB micro adaptor cable

Dimensions

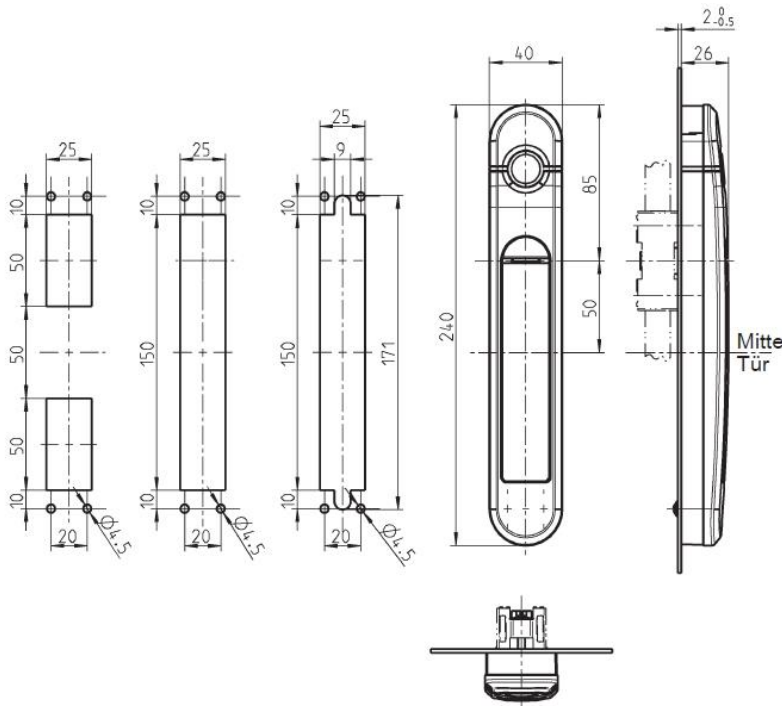

Fig. 8: Agent E for rod control 3000-U900-41

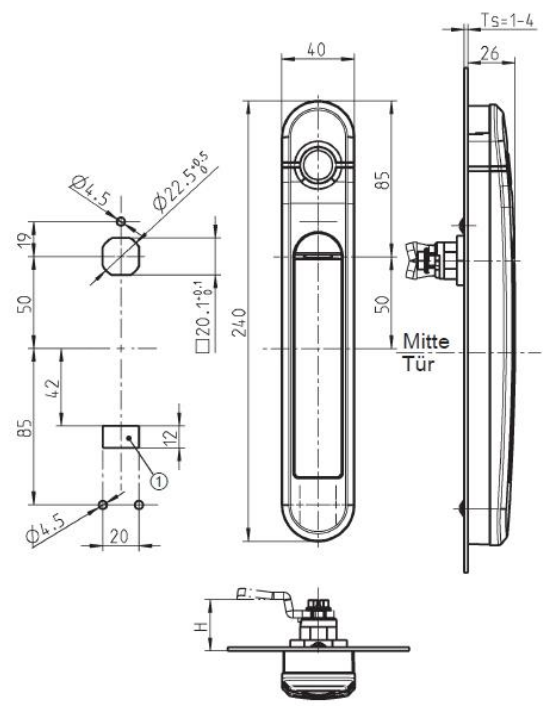

Fig. 9: Agent E for cam 3000-U900-42

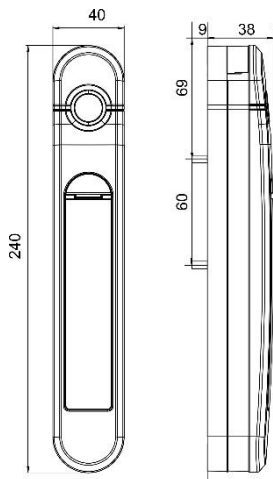

Fig. 10: Agent E for Rittal TS8 3000-U900-43

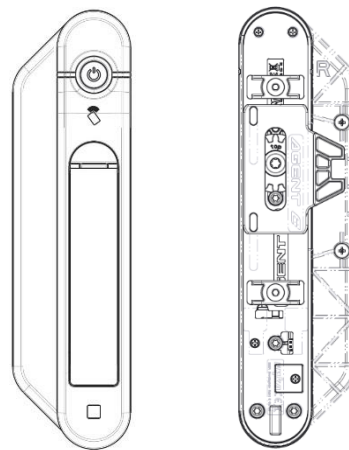

Fig. 11: Agent E for Emerson Knuerr (Vertiv) 3000-SU900-46 / -47