



Türkontakt

Dieser Reedkontakt ist zum Anschluss an Sensor-Komponenten des ELM Systems geeignet. Er kann universell für die Erkennung von Türöffnungszuständen oder Abstandsüberschreitungen eingesetzt werden. Er lässt sich z.B. als Türkontakt an einem ELM Locking Units anschließen oder als digitaler Sensor an einer ELM Sensor Unit betreiben.

3000-U35-00 Kabelende mit offenen Kontakten

3000-U35-01 mit Stecker für ELM 19"-Einschübe oder ELM Box-Module

Technische Änderungen vorbehalten.



Door contact switch

This reed contact can be connected to a module of the ELM system. It can be used to detect door-open status or distance transgression. It is suitable for connection to ELM handle or single point latch modules or as digital sensor on ELM sensor modules.

3000-U35-00 open cable ends

3000-U35-01 with connector plug for ELM 19"-racks or ELM box modules

Subject to technical changes.



Fig. 1: 3000-U35-01

Plug front side view	Pin number of plug	Signal	Wire color
	1	contact	white
	2	(not used)	-
	3	(not used)	-
	4	contact	white

Fig. 2.: Dimensions (reed contact and magnet)
Holes diameter: 4mm

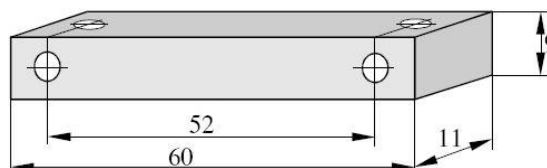

Characteristics

- Approval: VdS: G193704 class A
- Switching distance between reed contact and magnet: 10 mm
- Contact rating : max. 30 V DC, max. 100 mA
- Cable length: 4 m

Using with ELM 3000-U11 / U12

Connection like (reed) contact of electronic swing handle or single point latch – the output of the module port is not used.

Using with ELM 3000-U13

This contact may be connected to an analog input of the 3000-U13. It allows switching relays and/or initiation of alarm, dependent on the contact status. Note that the contact in this application switches +12 V to the sensor input, this is out of measuring range but not out of maximum input voltage - the measured value with closed contact will be about 8 V.

Parameters example for ELMControl:

lower end of scale	lower limit	upper end of scale	upper limit	fitting scale	fitting offset	lower set point	upper set pint
0	0 mV	1	5000 mV	0.0002	0	0.5	0.5