

**Complete multi-point locking system
made of high quality plastic**

Locking components for a wide range of solutions on doors and flaps

- The rod guide can be fixed to the door with M6x10 welding studs or M6x10 carriage bolts.
- The trapezoidal contour of the rod guide and catch ensures that the door closes precisely.
- The locking components are symmetrical, which allows for easy change of the hinge side of the door.
- The rod adapter is clipped without tools to the rod, and the flat rod holders.
- The shoe is inserted into the end of the rod, and the locking plate is attached to the inner door frame. This allows the use of locking systems inside the seal.

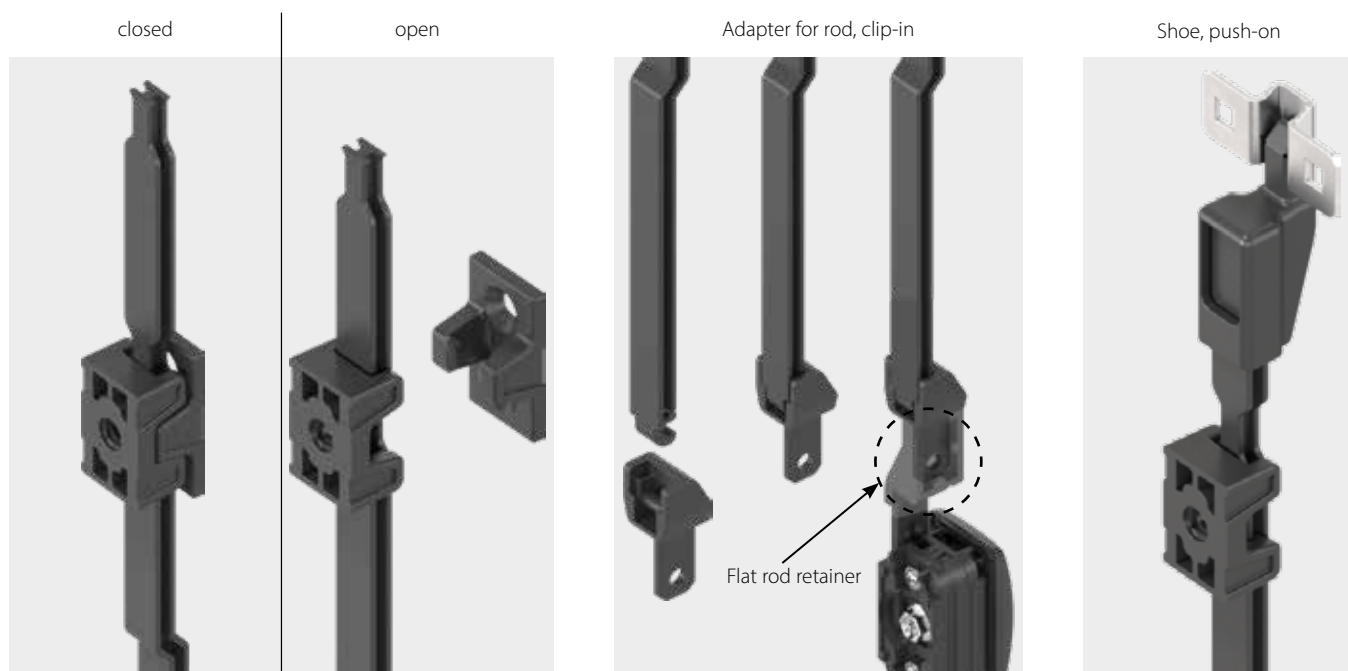

Rod guide
Polyamide GF black
1190-30-01
for weld stud M6x10
and flat nut M6

Catch
Polyamide GF black
1190-31-01
Outside the sealing

Rod adapter
Polyamide GF black
1190-33-01

Locking plate
Steel zinc-plated
1190-34-02

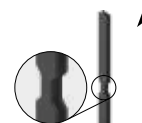

Shoe
Polyamide GF black
1190-32-01
Inside the sealing



Door height	Number of catches and rod guides for locking systems outside the seal	Rod 2 x
800 - 1,200	2	1190-21-01AA
1,200 - 1,600	2	1190-21-01AA
1,600 - 1,900	4	1190-21-AA
1,900 - 2,200	4	1190-21-AA

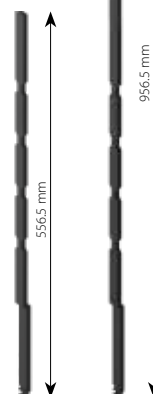

Complete multi-point locking system inside or outside the seal

- It is suitable for inside or outside the seal for door heights from 800 to 2,200 mm.
- The plastic rod can be fitted to all EMKA lift handles and combined with all EMKA escutcheons and swing handles with a rod control.
- The plastic used is corrosion-resistant, non-conductive, and lighter than comparable locking solutions made of metal.
- The **plastic components are approx. 30% cheaper** and have **only approx. 20% less strength** than the comparable steel versions.

Application examples of locking systems with plastic connecting rods

Unidirectional lifthandle 1190
with round cylinder EK 333



Stroke = 18 mm

Bi-directional lifthandle 1390
with double bit 3 mm



23.5 mm

Swinghandle 1325
with square 8 mm and
rod control 1121-U26-K



23.5 mm

3-point locking system
inside the seal
Small escutcheon 1121
with double bit 5 mm and
rod control 1121-U1-K
Cam 1000-13



23.5 mm

EMKA worldwide

 ALGERIA EMKA France Tel. +33/254/320862 emka@emka-france.com	 FRANCE EMKA France Tel. +33/254/320862 emka@emka-france.com	 MONTENEGRO EMKA Bosnia Tel. +387/38/241310 info@emka.ba	 TUNISIA EMKA France Tel. +33/254/320862 emka@emka-france.com
 ARMENIA EMKA Kilit Tel. +90/262/2909097 info@emkakilit.com.tr	 GEORGIA EMKA Kilit Tel. +90/262/2909097 info@emkakilit.com.tr	 NETHERLANDS EMKA Benelux Tel. +31/413/323510 info@emka.org	 TURKMENISTAN EMKA Kilit Tel. +90/262/2909097 info@emkakilit.com.tr
 AUSTRIA EMKA Beschlagteile Ges.m.b.H. Tel. +43/2143/43063 info@emka-beschlagteile.at	 GREECE * EMKA Hellas Tel. +30/21041/83183 info@emka-hellas.com	 NORWAY EMKA Scandinavia Tel. +46/36/314130 info@emka.se	 TURKEY EMKA Kilit Tel. +90/262/2909097 info@emkakilit.com.tr
 AUSTRALIA EMKA Pacific AU Tel. +61/3/93386958 sales@emka.com.au	 HUNGARY EMKA Beschlagteile Ges.m.b.H. Tel. +36/1/2360032 info@emka.hu	 POLAND EMKA Polska Tel. +48/32/6663300 info@emka.net	 UAE EMKA Middle East Tel. +48/32/6663300 info@emka.ae
 AZERBAIJAN EMKA Kilit Tel. +90/262/2909097 info@emkakilit.com.tr	 INDIA EMKA India Tel. +91/80/48542727 info@emka.in	 PORTUGAL EMKA Beschlagteile Ibérica Tel. +34/672/262672 info@emka.pt	 UKRAINE EMKA Ukraine Tel. +380/96/7535875 info@emka.in.ua
 BELGIUM EMKA Benelux Tel. +31/413/323510 info@emka.org	 INDONESIA EMKA Pacific Tel. +62/22/87301000 info@emka-pacific.id	 ROMANIA S.C. EMKA Beschlagteile Tel. +40/269/222700 info@emka.ro	 UNITED KINGDOM EMKA (UK) Tel. +44/2476/616505 info@emka.co.uk
 BOSNIA-HERZEGOVINA EMKA Bosnia Tel. +387/38/241310 info@emka.ba	 ISRAEL * Kornass Mechanical Engineering Tel. +972/76/5400789 sales@kornass.com	 SERBIA EMKA Okovi Tel. +385/35/270073 info@emka-okovi.hr	 USA EMKA Inc. Tel. +1/717/9861111 info@emkausa.com
 CANADA EMKA Inc. Tel. +1/717/9861111 info@emkausa.com	 ITALY EMKA Italia Tel. +39/045/6471070 info@emka.it	 SINGAPORE * VF Fastening Systems Tel. +65/6752/3033 vincent@vffastening.com.sg	 UZBEKISTAN EMKA Kilit Tel. +90/262/2909097 info@emkakilit.com.tr
 CHINA EMKA Industrial Hardware Tel. +86/22/22242300 info@emka.cn	 JAPAN * TOCHIGIYA Tel. +81/48/2283072 support@tochigiya.co.jp	 SLOVAKIA EMKA Beschlagteile Ges.m.b.H. Tel. +42/190/3446826 mifo.herman@gmail.com	 VIETNAM * DNP - Dai Nguyen Phat Tel. +84/356/951724 ltnn@dainguyenphat.com
 CROATIA EMKA Okovi Tel. +385/35/270073 info@emka-okovi.hr	 KAZAKHSTAN EMKA Kilit Tel. +90/262/2909097 info@emkakilit.com.tr	 SOUTH AFRICA * Enclosure Solutions Tel. +27/11/9737260 info@enclosuresolutions.co.za	
 CZECH REPUBLIC EMKA Beschlagteile CZ Tel. +43/214343063 info@emka-solutions.cz	 LATVIA EMKA Polska Tel. +370/612/42868 m.balsevicius@emka.net	 SOUTH COREA * Geo Jeon Tel. +82/314/335508 geojeon@emkakorea.co.kr	
 DENMARK * A/S Megatrade Beslag Tel. +45/44916700 mega@megatrade.dk	 LITHUANIA EMKA Polska Tel. +370/612/42868 m.balsevicius@emka.net	 SPAIN EMKA Beschlagteile Ibérica Tel. +34/672/262672 info@emka-iberica.es	
 ESTONIA EMKA Polska Tel. +370/612/42868 m.balsevicius@emka.net	 MOROCCO EMKA France Tel. +33/254/320862 emka@emka-france.com	 SWEDEN EMKA Scandinavia Tel. +46/36/314130 info@emka.se	
 FINLAND EMKA Scandinavia Tel. +46/36/314130 info@emka.se	 MEXICO EMKA Mexico Beschlagteile Tel. +52/44/22095217 info@emka.mx	 SWITZERLAND EMKA Beschlagteile AG Tel. +41/33/8260220 info@emka.ch	

*Agency

www.EMKA.com



EMKA Beschlagteile GmbH & Co. KG

Langenberger Str. 32 • 42551 Velbert, Germany • Tel.: +49/2051/273-0 • Fax: +49/2051/273-128 • E-Mail: info@emka.com • www.emka.com

